



HEAT & COLD PROOF

# INSULATION

— TILES —

**National Tiles** has developed Insulation Tiles for Roof & Terraces with Special Heat Reflective glaze (HRNT-613) which contributes to energy saving by decreasing cooling & heating cost.



**National Tiles  
& Ceramics Ltd.**

[www.nationaltiles.com](http://www.nationaltiles.com)

# National Tiles

## Heat Insulation Tiles

National Tiles has developed Insulation Tiles for Roof & Terraces with Special Heat Reflective glaze (HRNT-613), which contributes to energy saving by decreasing cooling & heating cost.

National Insulation Tiles consist of 34mm thickness with cavity of 12mm HRNT-613 (I). The Tiles are highly durable and enable significant energy saving on non-insulated and poorly insulated roofs and provides large saving in term of energy costs and normal insulation cost.

National Insulation Tiles are also available in 10mm HRNT-613 (N) thickness which insulate 30% less insulation compared to 34mm (Cavity) Tiles.

Now you can have the advantage of National Insulation Tiles for the insulation from heat/ Cold and frost proofing of roofs of residential projects, industrial projects, commercial buildings and storage facilities.

### Heat Radiation Through The Roof

Radiation from the sun can increase the temperature on a flat roof surface very high. The heat penetrates via the top layer to the inside, resulting in temperatures in the underlying building and/or level increasing to extreme heights (Figure 1a).

By installing National Insulation Tiles on top of the existing roof, the sun's radiation can no longer reach the underlying roof and thus prevents it from warming up. (Figure 1b) The inside temperature will be reduced, which provides a more pleasant and comfortable work environment.

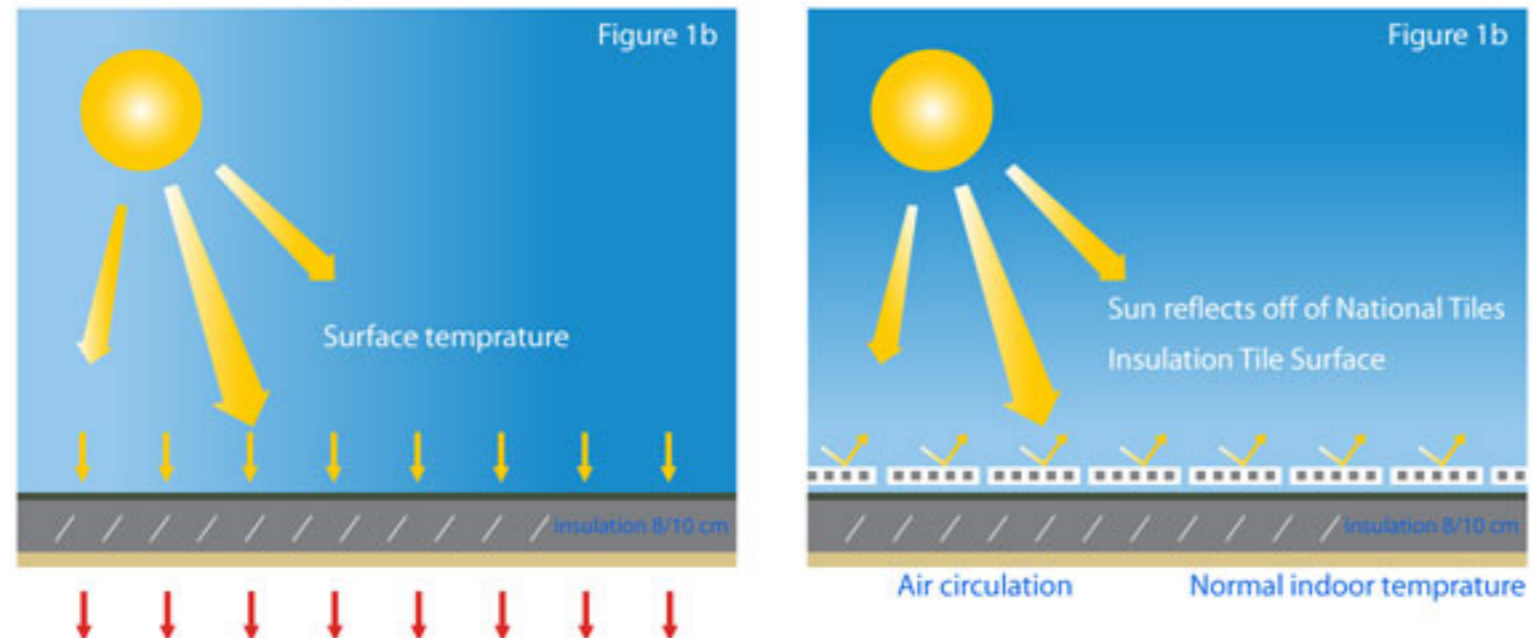

A financial benefit of the Insulation Tiles by National Tiles® on the roof is that the high energy cost for cooling (air-conditioning, etc.) in the building are diminished significantly as it costs approximately 7 times more energy to cool a building than to heat it. The benefits are clear for many residential projects, commercial properties, offices, hospitals and schools etc. (figures 3a and 3b).

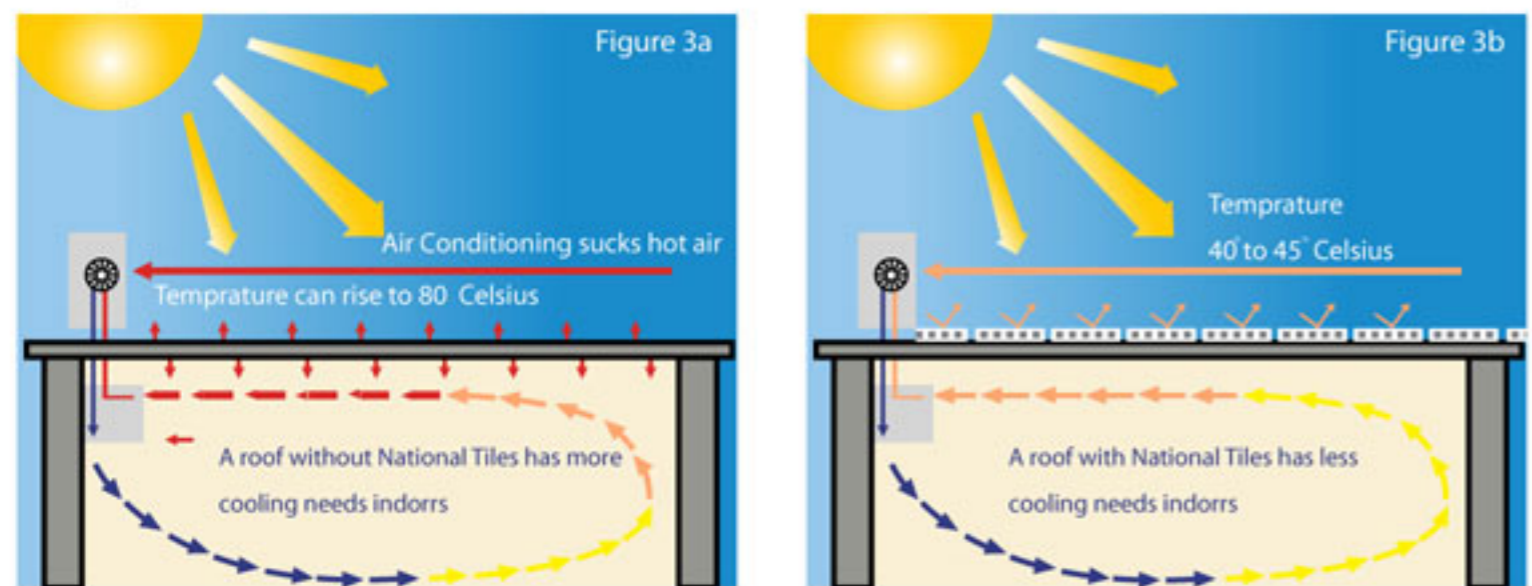

### Low Temperatures

National Insulation Tiles provide extra energy savings during cold periods too. During colder periods with frost over the roof tiles, a clear difference in temperature is noticeable. Measuring Results of January 2010 (frost) on the bare roof shows low (-) temperatures, while at the same time under the National Tiles they show warmer temperature. Snow is also prevented from making direct contact with the Insulation material, resulting in the formation of an insulating blanket above the cavity layer and creating a layer of still air that provides extra insulation (figure4a&4b).

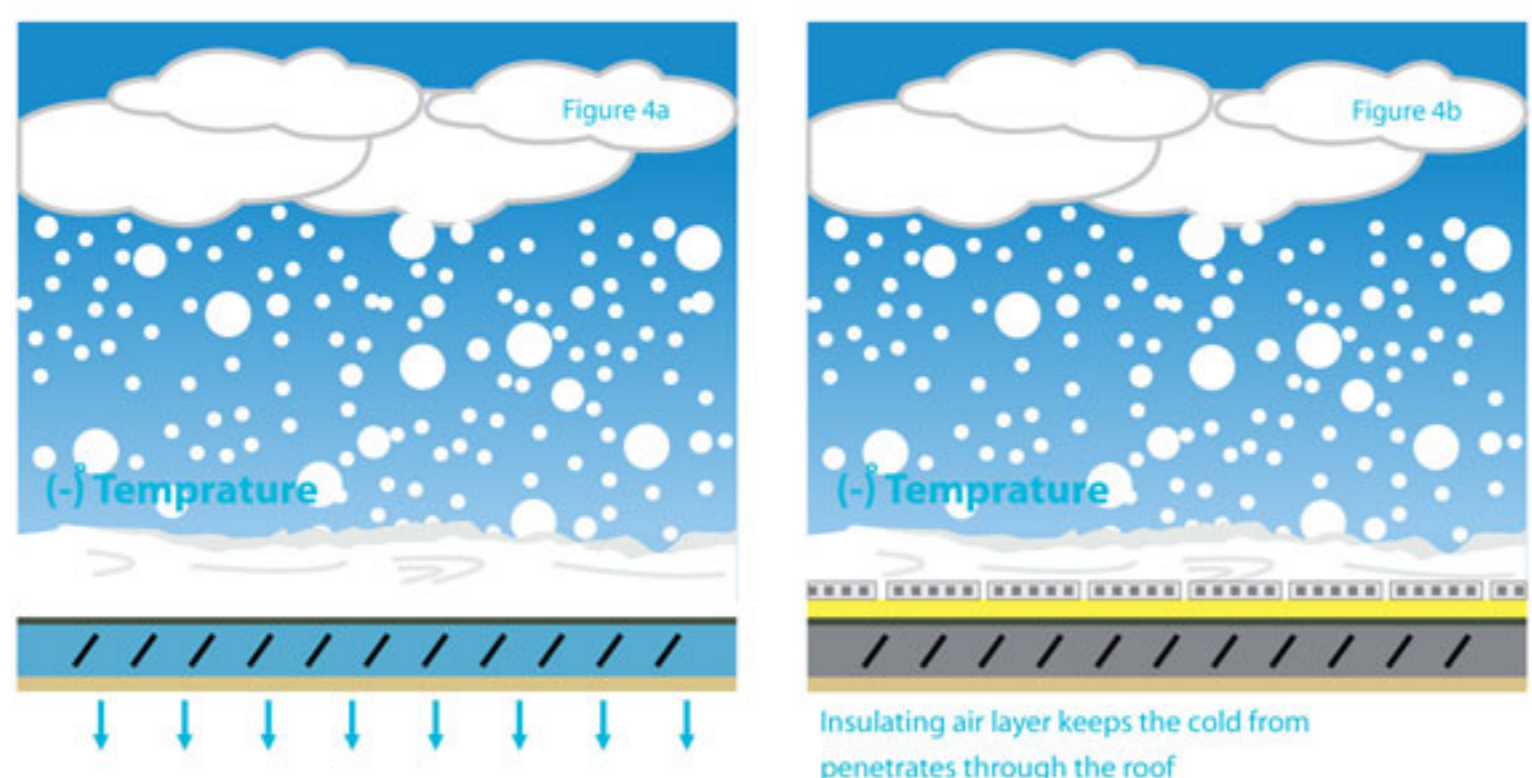

### Advantages:

#### CSR (Corporate Social Responsibility):

This attaches great importance to the criteria set by the government on CSR (Corporate Social Responsibility). With the large savings made by National Insulation Tiles in both energy and raw materials, greenhouse gas emissions and its own purchasing and production policies, this lines up perfectly with the criteria for CSR (Corporate Social Responsibility) as drawn up by most other countries.

#### Environmentally-friendly approach:

An environmentally-friendly approach is essential for the economy. All the waste from the manufacturing process is recycle and reused in the production. This involves non-fired tiles rejected throughout the manufacturing process, or tiles found defective after the firing phase. All waste water is filtered using a special technological procedure and re-used together with the filtered solid particles in the manufacturing process. The manufacturing process only uses natural materials without the content of heavy metals. Generally, it is a waste-less technology.

#### A summary of the benefits:

- Using top of the line state-of-the-art technology.
- Can be used on many roofs without any necessary adjustments by just using cement.
- The roof can be utilized for conducting any event, as the roof looks neat and tidy.
- Extends the life of the underlying roof.
- Large energy savings to be achieved and thus CO<sub>2</sub> reduction and financial benefits
- Comfortable living / working climate.
- Decrease of needed cooling power
- Temperature difference indoors can reduce
- Large savings on staff downtime and productivity
- User-friendly (Useable roof for work space or organizing any event)
- You show corporate social responsibility.
- Can take movable weight.
- Prevents odor of bitumen.
- High foot traffic is possible.
- Long-term high insulation efficiency.
- Excellent compressive strength.
- Anti-slip
- UV and infrared resistant.
- No maintenance.
- Storm-proof.
- Uniform density distribution.
- Resistance to aging and rotting
- High resistance to thermal cycle.
- Investment in the future.
- Aesthetically pleasing.
- Thoroughly closed-cell structure.

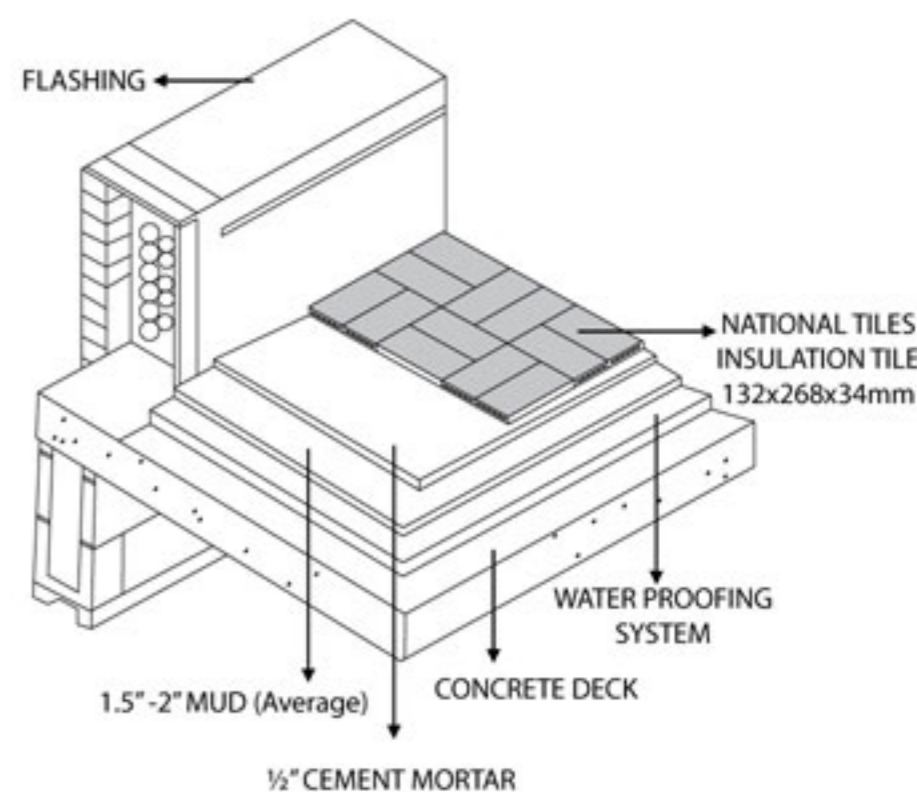

### Usage:

- Roof Insulation of Residential complexes (Apartments, Bungalows etc.)
- Roof Insulation of Pharmaceuticals Factories
- Roof Insulation of Commercial & Industrial buildings
- Roof Insulation of Cold Storages (Perishable items)
- Roof Insulation of Poultry Farms, Meat Farms etc.
- Roof Insulation of Water Tank, Acid Tanks etc.

### Reflection provides a high albedo (extent of reflection of light.):

The HRNT613 glaze provides high reflection of the sun's radiation (85%) resulting in the ambient temperature being significantly reduced. Keeping this in mind, the National Insulation Tiles can be used as an effective measure against Urban Heat Island Effect (UHI). Also, smog and particulates in industrial development and / or urban areas are contained. This special reflective glaze is used on 2 thicknesses tiles. The two options in thicknesses are available to cater the price sensitive clients as well.

### HRNT613 thickness options for Heat Insulation Tiles:

- 1- HRNT 613 (I) 34 mm (Insulation Tiles)
- 2- HRNT 613 (N) 10 mm (Non Cavity Tiles - will achieve about 30 to 35% of the result and saves cost)

| No. | Sizes/Type                    | HRNT613 (N)<br>132x268mm | HRNT613 (I)<br>132x268mm |
|-----|-------------------------------|--------------------------|--------------------------|
| 1   | Thickness (mm) Approx         | 10mm                     | 34mm                     |
| 2   | Weight Per Box. (KG) Approx   | 11 KG                    | 10 KG                    |
| 3   | No. of Tiles per Box          | 14                       | 5                        |
| 4   | Sq. Mtr. Per Box              | 0.50 Sq. Mtr             | 0.20 Sq. Mtr             |
| 5   | No. of Boxes per Sq. Mtr      | 2                        | 5                        |
| 6   | Sq. Mtr per 20 Feet Container | 800                      | 300                      |

| COMPARE DIFFERENT TYPES OF ROOF WHEN TEMPERATURE IS 40 DEGREE CELSIUS. IN BETWEEN 12 NOON TO 4PM |  |   |                         |
|--|--|---|-------------------------|
| DIFFERENT TYPES OF ROOF  | LASER SOPT TEMPERATURE. ROOF FLOOR OUTSIDE | LASER SPOT TEMPERATURE. ROOF CEILING INSIDE | INSIDE ROOM TEMPERATURE |
| NORMAL CONCRETE ROOF   | 55 DEGREE CELSIUS                          | 39 DEGREE CELSIUS                           | 37 DEGREE CELSIUS       |
| BITUMINOUS SURFACE ROOF  | 65 DEGREE CELSIUS                          | 42 DEGREE CELSIUS                           | 40 DEGREE CELSIUS       |
| National Tiles HRNT 613 (I)  | 50 DEGREE CELSIUS                          | 38 DEGREE CELSIUS                           | 34 DEGREE CELSIUS       |

**Karachi Showroom:** No. 1 Services Mess, Behind Hotel Metropole Saddar, Karachi. Ph: 021- 35213696, 35213143 Fax: 021-35681137 MOB: 0321-8257766, 0300-8247246

**Lahore Showroom:** I-Saint Marry Park, Near Kalma Chowk, Gulbarg-III, Lahore. Ph: 042-35882827, 35751791 Fax: 042-35851635 MOB: 0300-8494150

**Islamabad Showroom:** I-Pindi Cricket Stadium Road, Islamabad. Ph: 051-4455551, 4422468 Fax: 051-4455551 MOB: 0300-5000512, 0321-5000512

**E-mail:** sales@nationaltiles.com **Website:** www.nationaltiles.com